

| FREE

B&Q

Bedrooms

Buying Guide

Friday 25th April – Thursday 11th September

Welcome...

This Bedroom Buying Guide works in conjunction with our new B&Q Bedroom Ideas Book. The Buying Guide gives you precise details about every bedroom product – choice, description, specification, price and availability. Combined with the inspirational Ideas Book you'll have everything you need to make the perfect choice for your bedroom. If you do need any additional help, our trained in-store advisors will be happy to give you further advice.



Your personalised bedroom

**Great quality products
at fantastic low prices,
every week**

At B&Q we are committed to ensuring that your bedroom shopping experience is as simple as possible. From choosing and designing your bedroom, through to delivery and installation, we are on hand to guide and support you every step of the way. We have everything that you need in one place, all backed by an uncompromising service and quality promise, giving you complete confidence and peace of mind.

Extensive product ranges including modular, sliding door and freestanding bedroom furniture.

COOKE[™]
&LEWIS



Always lowering the cost



Our price promise

This is our promise to you. So you can happily buy anything from us safe in the knowledge that, if you find any products even 1c cheaper somewhere else within the Republic of Ireland, we'll refund the difference and give you an extra 10% off the lower price.

Why pay more?

Lowering costs, never compromising on quality

This is at the heart of what we stand for... At B&Q we're able to offer you exceptional quality products and ranges at low prices. We offer fair and honest pricing that our customers can trust and unlike other companies, we'll never artificially inflate prices only to slash them later in the year to appear as a great money saving deal. This is simply dishonest and unfair on you.

B&Q

Homefit

APPROVED

tradesmen - fixed prices

Helping you with your project

Your step-by-step guide of what to expect...

The whole idea of the project may seem daunting but we're here to make it easy, and most importantly, enjoyable. We promise to do everything we can to ensure your project runs smoothly at every stage of the journey.

1. Inspiration

So what is it you're looking to do? Repair, refresh, maintain or get something totally new? We can inspire you with great ideas that suit you, your budget and your lifestyle. You may even need help with financing and installation which we will discuss with you.



2. Planning

Once inspired, we'll need you to get a few simple room measurements to help us move forward with your project. It's really simple and we'll give you guidance on how to measure, plan and make the best use of your space.



4. Create the look

You will now have a clear vision of your kitchen, bedroom or bathroom. You may want to look at how you can personalise your room and make it truly yours. Whether that's lighting, flooring, tiling, colour schemes or accessories, we have everything you'll need to create your desired look. We can even help you tile, lay flooring, paint and more so you don't have to.



3. Designing

With our totally free design consultation, we will bring your ideas to life with our leading 3D design software. We'll also need to look at heating, plumbing and electrics to see if they are affected by the project.



5. Budgeting

Following our survey, we will know exactly how much the project will cost you. But rest assured, our prices won't be beaten, and that's a promise.



6. Installing

Your kitchen, bedroom or bathroom is ready to take its place in your home. Whether you've chosen to have it fully installed by our market leading installation service (see pages 10-11) or just to have items delivered through our flexible delivery options (see page 135), we'll make things easy and provide helpful advice at every stage. We can even help you with great tips to install yourself, either the full project or parts of it.



5 year installation guarantee

Market leading

Professionally fitted

Deciding which kitchen, bedroom or bathroom is perfect for you is one thing, but we know that not everyone has the time or experience to install it themselves. We can take care of your project from installation to plumbing, electrics, gas works, flooring, plastering, tiling and joinery. With over 15 years of domestic installation experience, over 1/2 million completed projects and international accreditation, you're in safe hands, we're the most experienced national retailer in the UK and Ireland.

All projects are managed locally so you'll always have somebody close by to contact if you need any help or advice. Once the work has been completed, and we've checked that you're happy, you will receive a 5 year workmanship guarantee; **the best of any national retailer in the UK and Ireland today.**

Kitchens, bedrooms & bathrooms



You're in safe hands

Helpful 'How to Measure' tips and advice for your bedroom

1

The overall room layout

- Sketch the outline of your room
- All you require is the general shape

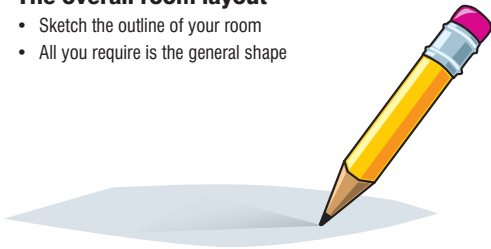

2

Indicate openings – windows, doors, archways and hatched

- Mark the location of windows, doors, archways, hatches
- Include the opening swing of doors

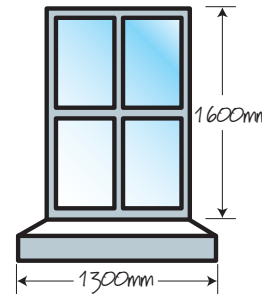

3

Indicate any obstacles that can't be moved and include main services, electric, water and gas

- Indicate items that must be planned around
- Your boiler, meters, radiators, soil stack, stop cock, alcoves, etc
- Finally add main services, electric, water and gas

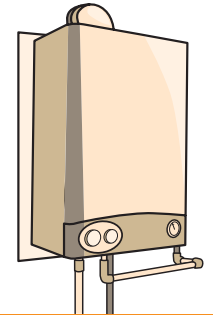

4

Measure between each fixed point – doors, walls and windows

- Pick a logical starting point like a corner and work clockwise around the room to avoid missing anything
- When measuring doors and windows remember to include frames and architrave, together with the distance from the floor to the underside of the windows

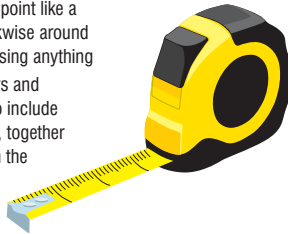

5

Measure obstacles in the room

- Your soil stack and boiler, radiators, etc
- Remember to include the width, depth and height of each item
- Show the obstacle heights and their distance from the floor in mm e.g. H=700mm F=1200mm

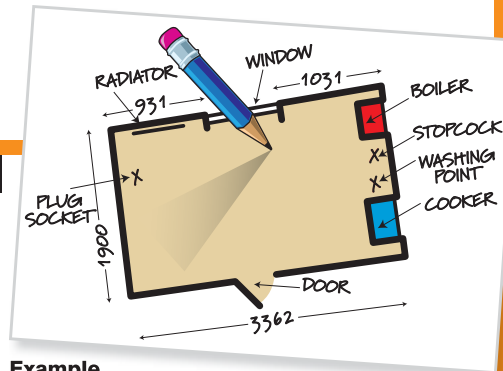

6

Measure main services, electric, water and gas

- Measure from the nearest fixed point on your diagram to the centre line of each service
- Include sockets, phone, gas, water and TV points
- When measuring larger service items such as consumer units, gas meters and radiators, remember to include their width and height from the floor



7

Measure ceiling heights

- Take two or three measurements to ensure the ceiling is consistent and mark the height in the middle of your survey plan
- If there are obstacles on the ceiling such as a stair slope or landing, mark this on your sketch

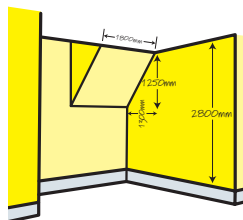

8

Example

Your sketch should look something like the example shown above. Now you're ready to start stage two of your project – Planning at B&Q

Helpful tips

- Remember walls aren't always perfectly square, so measure them at the top, middle and bottom.
- Bear in mind that switches, sockets and most radiators can be moved – you can discuss this with your B&Q designer.
- If you're keeping any freestanding appliances or furniture like tables and chairs, include their dimensions for your design consultation.
- Take photos of any particular feature or bits you're unsure about.
- Include for discussion any structural alterations you may want to make like moving doors.
- Once you've finished, double check your measurements for accuracy as this will make it easier to create your new project.

B&Q

Homefit

APPROVED tradesmen - fixed prices

You're in safe hands

Helpful 'How to Measure' tips and advice for your bedroom

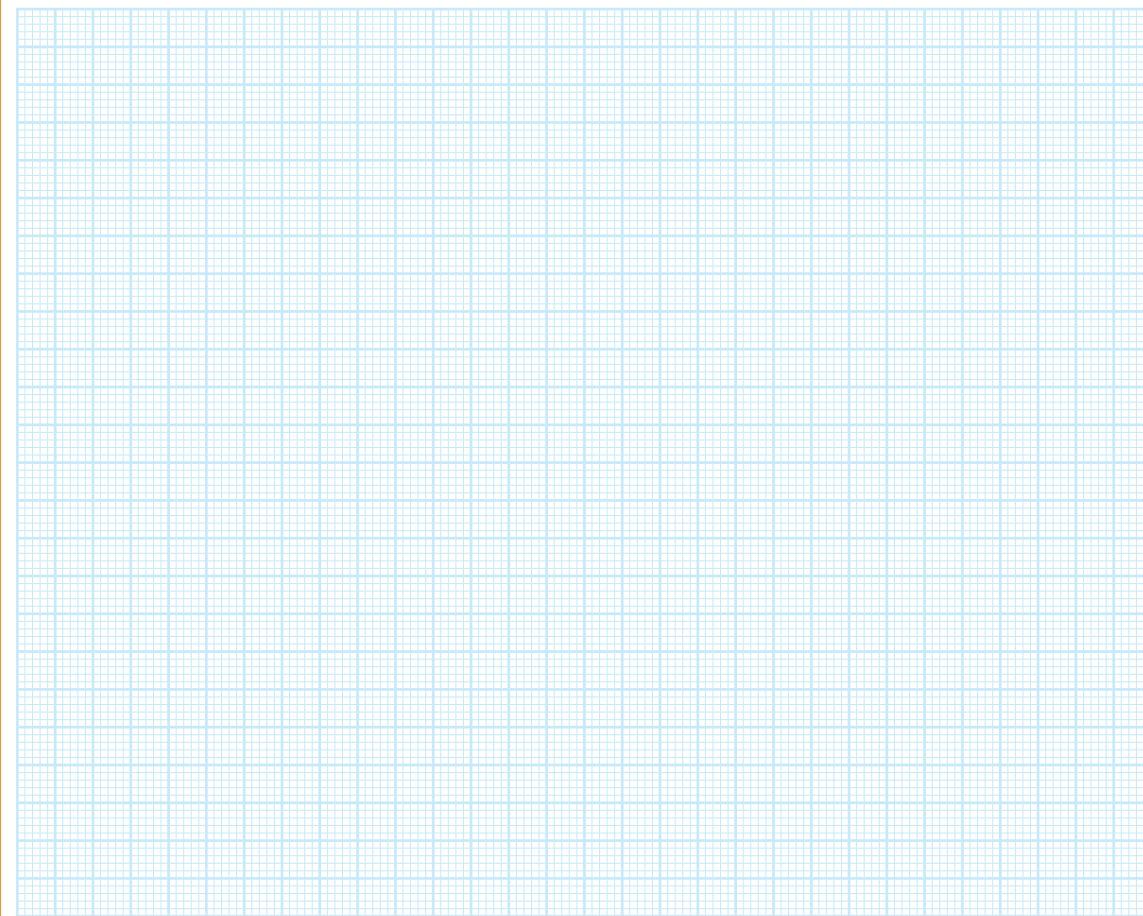

Checklist – have you...

- | | | | |
|--|--------------------------|--|--------------------------|
| <input type="checkbox"/> Drawn the shape of your room? | <input type="checkbox"/> | <input type="checkbox"/> Indicated width, depth and height of all obstacles? | <input type="checkbox"/> |
| <input type="checkbox"/> Drawn the location of the doors and windows? | <input type="checkbox"/> | <input type="checkbox"/> Indicated sockets, phone and TV points? | <input type="checkbox"/> |
| <input type="checkbox"/> Planned around any obstacles that can't be moved? | <input type="checkbox"/> | <input type="checkbox"/> Measured the ceiling height correctly? | <input type="checkbox"/> |
| <input type="checkbox"/> Added the main services, electric, water and gas? | <input type="checkbox"/> | <input type="checkbox"/> Measured any free-standing items such as furniture? | <input type="checkbox"/> |

When are you looking to change your room?

What are you looking to change?

- | | | | |
|------------------|--------------------------|-------------------|--------------------------|
| Complete project | <input type="checkbox"/> | Refresh | <input type="checkbox"/> |
| New doors | <input type="checkbox"/> | New cabinets | <input type="checkbox"/> |
| New worktops | <input type="checkbox"/> | New handles | <input type="checkbox"/> |
| New appliances | <input type="checkbox"/> | New sanitary ware | <input type="checkbox"/> |
| Other | | | |

Have you considered...

- | | | | |
|-------------|--------------------------|------------|--------------------------|
| Accessories | <input type="checkbox"/> | Sinks/Taps | <input type="checkbox"/> |
| Tiling | <input type="checkbox"/> | Heating | <input type="checkbox"/> |
| Lighting | <input type="checkbox"/> | Flooring | <input type="checkbox"/> |

Who is installing your bedroom?

- | | |
|---------------------------------|--------------------------|
| I'd like B&Q to give me a quote | <input type="checkbox"/> |
| Local Tradesman | <input type="checkbox"/> |
| Myself | <input type="checkbox"/> |

Freestanding bedrooms

Malmo 6

The distinctive style of solid Scandinavian stained pine* and the routed detail on the doors give a traditional feel to this range of bedroom furniture. To make the most of all available space, add a top box to your wardrobe for a clever storage solution.

									
2 Over 4 drawer chest H901 x W823 x D383mm	Merchants chest H741 x W1206 x D383mm	3 Drawer bedside chest H581 x W441 x D383mm	5 Drawer tallboy H901 x W441 x D383mm	Ottoman H450 x W828 x D417mm	Single pedestal dressing table H1801 x W885 x D506mm	2 Door 2 drawer combi wardrobe H1373 x W883 x D480mm	2 Door wardrobe H1853 x W883 x D570mm	3 Door 4 drawer wardrobe H1853 x W1296 x D570mm	Double bed frame** H935 x W1462 x L1997mm

Pine	5707252000196 €171	5707252016289 €224	5707252000165 €105	5707252000172 €118	5707252000349 €118	5707252000325 €171	5707252023102 €264	5707252023096 €251	5707252022846 €500	5707252001537 €198
White	5707252028916 €171	5707252029081 €224	5707252028893 €105	5707252028909 €118	5707252028923 €118	5707252028978 €171	5707252028886 €264	5707252028947 €251	5707252028985 €500	5707252028855 €198

Dimensions are approximate. Supplied flat packed. *Solid pine or white does not apply to back panels, drawer boxes and fittings. **Mattresses not included.

2 Door top box H416 x W883 x D570mm	2 Door top box H416 x W1296 x D570mm	Single bed frame** H935 x W1002 x L1997mm
5707252023089 €105	5707252023072 €158	5707252001520 €158
5707252029418 €105	5707252029425 €158	5707252028862 €158
		Kingsize bed frame** H935 x W1527 x L1997mm

Malmo 6

These solid Scandinavian stained pine* Malmo bookcases and sideboards are ideal as additional storage for your bedroom, home study or anywhere around the home.

			
Tall bookcase H1661 x W767 x D270mm	3 Door 3 drawer sideboard H789 x W1296 x D390mm	2 Door 2 drawer sideboard H789 x W883 x D390mm	Low bookcase H1021 x W767 x D270mm
5707252002626 €171	5707252000493 €238	5707252000530 €184	5707252002602 €105

*Solid pine does not apply to back panels, drawer boxes and fittings. Dimensions are approximate. Supplied flat packed. †Excludes 3 door glazed dresser and 2 door 2 drawer open dresser as no longer available.

Oslo 6

Oslo is light and airy with a soft cream effect which is complemented by solid pine tops and bun feet and handles.
To take care of all your storage needs, add a top box to your wardrobe.

										
3 Drawer bedside chest H581 x W441 x D383mm	2 over 3 drawer chest H741 x W823 x D383mm	Merchants chest H741 x W1206 x D383mm	2 over 4 drawer chest H901 x W823 x D383mm	Ottoman H450 x W828 x D417mm	Double bed frame* H935 x W1462 x L1997mm	2 Door wardrobe H1853 x W883 x D570mm	3 Door 4 drawer wardrobe H1853 x W1296 x D570mm	2 Door 2 drawer combi wardrobe H1373 x W883 x D480mm	2 Door wardrobe H1814 x W830 x D500mm	
6	5707252027568 €105	5707252027551 €158	5707252027674 €224	5707252020101 €171	5707252027698 €118	5707252027278 €238	5707252027544 €251	5707252027537 €500	5707252022433 €264	5707252021900 €171
						Single bed frame* H835 x W1002 x L1997mm 5707252027261 €211	2 Door top box H416 x W883 x D570mm 5707252022556 €105	3 Door top box H416 x W1296 x D570mm 5707252022563 €264		

Dimensions are approximate. Supplied flat packed. *Mattresses not included.

Millie



		
1 Drawer bedside chest H420mm x W380mm x D360mm	5 Drawer chest H900mm x W750mm x D360mm	Double wardrobe H1810mm x W700mm x D490mm
Acacia effect	5055772400362 €30.50	5055772400386 €77
		5055772400287 (box 1 of 2) €125
		5055772400294 (box 2 of 2) -

Supplied flat packed. Oak and acacia effect does not apply to back panels, drawer boxes and fittings. All dimensions approximate



Evie 6

		
1 Drawer bedside chest H293mm x W402mm x D342mm	4 Drawer chest H910mm x W702mm x D395mm	Double wardrobe H1800mm x W902mm x D582mm
Oak effect & white gloss	5706887973967 €37.20	5706887973950 €107
		5706887973936 (box 1 of 2) €155
		5706887973943 (box 2 of 2) -

Elsey 6

		
2 drawer bedside chest H450mm x W390mm x D400mm	4 drawer chest H740 x W760mm x D400mm	Double wardrobe H2000mm x W800mm x D520mm
Oak effect	5055772400263 €51.75	5055772400270 €126
		5055772400225 (box 1 of 2) €171

Isabella 6

		
2 Drawer bedside chest H482mm x W458mm x D419mm	2+2 Drawer chest H742mm x W430mm x D419mm	Double wardrobe H2030mm x W1043mm x D624mm
Soft white	5706887973912 €78.25	5706887973905 €131
		5706887973882 (box 1 of 2) €198
		5706887973899 (box 2 of 2) -

Form is a simple modular bedroom furniture concept that offers complete flexibility. Follow these 3 easy steps to create a storage solution that looks and performs exactly how you want it to.

Made from FSC certified wood, cabinets are fully wrapped so there are no exposed edges to chip or peel



Wardrobe cabinets

Assembly

- Available 500 and 1000mm wide
- Pre-drilled to make fixing doors internal accessories and joining cabinets easy
- Can stand alone, or join to create triple, quadruple wardrobes. There is no limit

Specification

- Strong, solid 18mm thick panels for sturdy construction
- All panels are fully wrapped so edges are smooth
- Include adjustable levelling feet

Style

- Choose from two versatile finishes – White or Cefalu oak effect
- Neutral cabinets allow you to match or contrast your doors and accessories



Doors and drawer fronts cabinets

Assembly

- Available 500mm wide
- Universal doors - hinge left or right handed (hinges come with doors)
- Push-to-open mechanism supplied with the mirror door

Specification

- Fully wrapped for smooth edges
- Gloss doors come with a protective film to be removed before handles are fitted

Style

- Choose from gloss, matt, textured or mirrored options
- Doors and drawer fronts colour-match or co-ordinate with cabinets
- Wide range of stylish handles to choose from



Chest cabinets

Assembly

- Available 500 and 800mm wide
- Drawer boxes included
- Can stand alone or join to create wider, fitted chest arrangements

Specification

- Strong, solid 18mm thick panels for sturdy construction
- All panels are fully wrapped so edges are smooth
- 6mm drawer bases for a solid construction

Style

- Choose from seven finishes
- Drawer fronts match or co-ordinate with cabinets and doors
- Wide range of stylish handles to choose from

Wardrobe cabinets



	White			Cefalu oak effect		
	Pack 1 of 2	Pack 2 of 2	Price	Pack 1 of 2	Pack 2 of 2	Price
500mm Single wardrobe cabinet H2004 x W499 x D566mm	5397007023527	5397007024128	€66.45	5397007027822	5397007027846	€66.45
1000mm Double wardrobe cabinet H2004 x W998 x D566mm	5397007026801	5397007026986	€79.70	5397007025606	5397007025781	€79.70

Wardrobe doors



	Textured white slab	Textured cefalu oak effect slab	Cefalu oak effect shaker	Gloss white slab	Gloss cream slab	Matt taupe slab	Traditional white	Mirror
Full height door front H1936 x W497 x D18mm	3454975901775 €33.20	5397007022766 €33.20	3454975901799 €46.50	3454975901836 €59.75	5397007027440 €59.75	5397007026146 €59.75	5397007038422 €73	3454975919763 €66.50

Shelves and drawers

		To fit wardrobe cabinet:	
		500mm Single H18 x W462 x D549mm	1000mm Double H18 x W962 x D549mm
Shelf pack Contains two shelves	White	3454975892226 €13.30	3454975892196 €19.95
	Cefalu oak effect	3454975892721 €13.30	3454975892691 €19.95
Drawers Include soft close runners	White	3454975892301 €39.90	3454975892295 €53
	Cefalu oak effect	3454975892806 €39.90	3454975892790 €53



Get creative! Combine single and double cabinets and mix décor doors, mirrored doors, shelves and drawers to create your own design



Step 2

Choose your chests and bedside cabinets

form

Chest cabinets



	White	Cefalu oak effect
3 Drawer narrow chest H760 x W500 x D500mm	5397007022889 €79.75	5397007023121 €79.75
3 Drawer wide chest H760 x W800 x D500mm	5397007022940 €126	5397007023220 €126
5 Drawer wide chest H1208 x W800 x D500mm	5397007023022 €179	5397007023305 €179

Step 3

Choose your door fronts

Drawer fronts



	Textured white slab	Textured cefalu oak effect slab	Cefalu oak effect slab	Gloss white slab	Gloss cream slab	Matt taupe slab	Traditional white
3 Drawer narrow chest fronts pack H221 x W497 x D18mm	5397007024029 €33.20	5397007023145 €33.20	5397007036589 €46.50	5397007027204 €59.75	5397007024166 €59.75	5397007026726 €59.75	5397007038446 €59.75
3 Drawer wide chest fronts pack H221 x W797 x D18mm	5397007024203 €46.50	5397007023206 €46.50	5397007036602 €59.75	5397007027242 €73	5397007024425 €73	5397007026863 €73	5397007038460 €93
5 Drawer wide chest fronts pack H221 x W797 x D18mm	5397007024340 €73	5397007023282 €73	5397007036626 €86.25	5397007027389 €99.75	5397007024586 €99.75	5397007027037 €106	5397007038484 €133



Wardrobe accessories

Design your wardrobe interior to fit your storage needs so it's completely individual to you. Everything is sized to fit perfectly in either a single 500mm or a double 1000mm cabinet.

See handles on pages 24-25



① Hanging rail

Single H80 x W460 x D22mm	
Grey	5397007040395 €6.65
Double H80 x W960 x D22mm	
Grey	5397007040418 €9.30

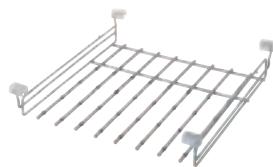

② Trousler rack

■ Requires multifunctional sliding frame	
Single H100 x W375 x D510mm	5397007040333 €26.60
Double H100 x W875 x D510mm	5397007040357 €33.20

Corner conversion kit

■ Maximise on space by fitting your wardrobes into a corner. You'll just need this kit to make sure the doors can still open.	
	3454975897382 €33.20

③ Shoe rack

■ Requires multifunctional sliding frame	
H200 x W390 x D510mm	5397007040371 €26.60



Multifunctional sliding frame

■ Includes smooth closing runners	
Single H85 x W465 x D500mm	5397007040210 €33.20
Double H85 x W865 x D500mm	5397007040234 €39.90



Wire basket

■ Requires multifunctional sliding frame	
Single H150 x W390 x D510mm	5397007040258 €19.95
Double H150 x W890 x D510mm	5397007040272 €26.60



Plastic tray

■ Requires multifunctional sliding frame	
H85 x W320 x D510mm	5397007040296 €19.95



Laundry bag

■ Requires multifunctional sliding frame	
H390 x W380 x D510mm	5397007040319 €19.95

Choose your modular furniture 6

Select the cabinets that fit your space and layout, in the format and finish of your choice. Then add doors and drawer fronts – choose from a wide range of wood grain effects, colours, mirrored and frosted glass

Wardrobe cabinets

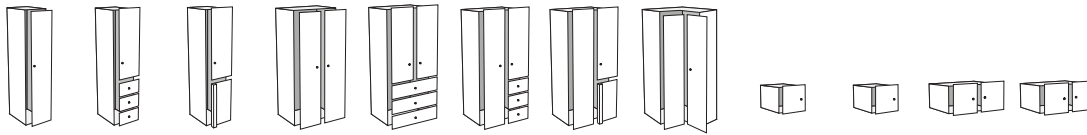

All cabinet interiors have a light wood grain effect

	Single wardrobe	Single combi wardrobe	Single stable wardrobe	Double wardrobe	Double linen wardrobe	Double combi wardrobe	Double stable wardrobe	Corner wardrobe*	Standard single bridging unit	Full depth single bridging unit	Standard double bridging unit	Full depth double bridging unit
		Includes combi conversion kit	Includes stable conversion kit and scribing panel		Includes linen press conversion kit	Includes combi conversion kit	Includes stable conversion kit and scribing panel			Can also be used on top of a single wardrobe		Can also be used on top of a double wardrobe
	H2112 x W450 x D589mm Comes complete with single shelf and 2 hanging rails			H2112 x W900 x D589mm Comes complete with single shelf and 2 hanging rails				H2112 x W1060 x D1040mm	H444 x W400 x D444mm	H444 x W450 x D589mm	H444 x W800 x D444mm	H444 x W900 x D589mm
Ferrara oak style	€179 3720370	€266 3720929	€266 3860885	€219 3720387	€345 3720905	€345 3720912	€345 3860922	€452 3720394	€73 3658420	€79.75 3854778	€86.25 3658352	€93 3854914
Walnut style	€179 3720998	€266 3721049	€266 3860908	€219 3721001	€345 3721025	€345 3721032	€345 3860946	€452 3721018	€73 3658444	€79.75 3854792	€86.25 3658376	€93 3854938
Maple style	€179 3720936	€266 3720981	€266 3860892	€219 3720943	€345 3720967	€345 3720974	€345 3860939	€452 3720950	€73 3658413	€79.75 3854785	€86.25 3658345	€93 3854921
Cream	€179 3721056	€266 3721100	€266 3860915	€219 3721063	€345 3721087	€345 3721094	€345 3860953	€452 3721070	€73 3658437	€79.75 3854907	€86.25 3658369	€93 3854945
You will also need	1 x full height door 1 x handle	1 x linen door 1 x combi drawer fronts pack 4 x handles	1 x linen door 1 x fitted chest* (see page 40)	2 x full height doors 2 x handles	2 x linen doors 1 x linen drawer fronts pack 5 x handles	1 x full height door 1 x combi drawer fronts pack 5 x handles	1 x full height door 1 x linen door 1 x fitted chest* (see page 40)	2 x full height doors 1 x handle	1 x standard bridging cabinet door 1 x handle	1 x standard bridging cabinet door 1 x handle	2 x standard bridging cabinet doors 2 x handles	2 x standard bridging cabinet doors 2 x handles

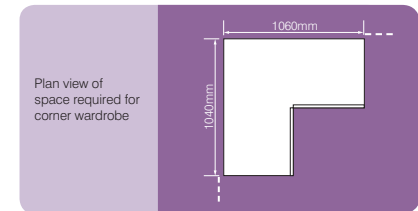
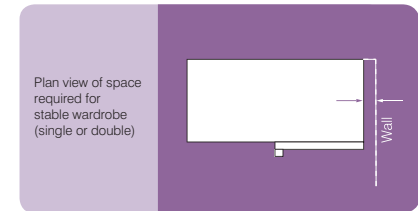

*Corner wardrobe comes complete with corner shelf, 2 hanging rails and interior shelves

Dimensions are approximate. All bedroom units supplied flat packed.
*Stable wardrobe can be used with any fitted dressing table or chest up to 747mm high.
All robes come with soft close hinges.

Wardrobe doors and drawer fronts

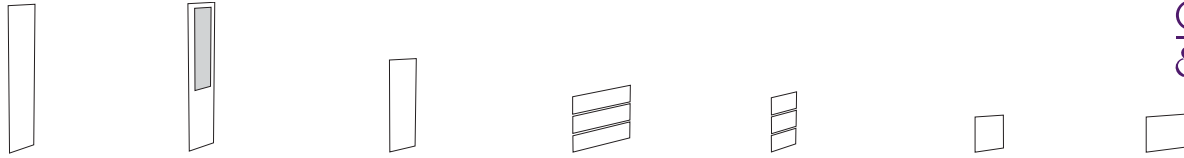

	Full height door	Full height door with mirror	Linen door	Linen 3 drawer fronts pack	Combi 3 drawer fronts pack	Standard bridging cabinet door	Full depth bridging cabinet door
	H2028 x W446 x D18mm	H2028 x W446 x D18mm	H1356 x W446 x D18mm	H219 x W896 x D18mm (per drawer front)	H219 x W446 x D18mm (per drawer front)	H440 x W396 x D18mm	H440 x W446 x D18mm

Contemporary doors Slab style doors and drawer fronts in wood grain effect give a modern and stylish look to any bedroom.

Designer cappuccino gloss	€106 3704769	–	€66.50 3705551	€73 3705575	€59.75 3705704	€39.90 3702512	€46.50 3850381
Designer vanilla gloss	€106 3567562	–	€66.50 3567579	€73 3567586	€59.75 3567593	€39.90 3702543	€46.50 3850114
Designer white gloss	€106 3567425	–	€66.50 3567432	€73 3567449	€59.75 3567456	€39.90 3702536	€46.50 3850220
Designer black gloss	€106 3705933	–	€66.50 3705940	€73 3705957	€59.75 3705964	€39.90 3706008	€46.50 3849705
Ferrara oak style	€66.50 3567340	–	€53 3567357	€53 3567364	€39.90 3567371	€33.20 3702611	€39.90 3850688
Walnut style	€66.50 3577448	–	€53 3577530	€53 3577653	€39.90 3577714	€33.20 3720851	€39.90 3853429

Multicolour doors These burgundy slab style doors and drawer fronts will add a splash of colour to your bedroom.

Designer burgundy gloss	€106 3567630	–	€66.50 3567647	€73 3567654	€59.75 3567661	€39.90 3702550	€46.50 3850305
-------------------------	--------------	---	----------------	-------------	----------------	----------------	----------------

Authentic doors A classic shaker panelled design with matching drawer front. Add a modern twist with mirror shaker doors.

Maple style shaker	€73 3567265	€79.75 3700914	€59.75 3567272	€59.75 3702567	€46.50 3702574	€33.20 3702529	€39.90 3849972
Ferrara oak style shaker	€73 3700969	€79.75 3700921	€59.75 3700976	€59.75 3700983	€46.50 3701300	€33.20 3701362	€39.90 3852279
Walnut style shaker	€73 3577455	€79.75 3700938	€59.75 3577554	€59.75 3577660	€46.50 3577721	€33.20 3701379	€39.90 3852293
Cream style shaker	€73 3798522	€79.75 3798515	€59.75 3798539	€59.75 3798553	€46.50 3798560	€33.20 3798546	€39.90 3852255

Heritage doors These classic panelled doors and stylish designer patterned doors add a touch of opulence and grandeur.

Traditional cream	€73 3577462	–	€59.75 3577608	€59.75 3577677	€46.50 3577738	€33.20 3720875	€39.90 3853535
Traditional maple style	€73 3577424	–	€59.75 3577509	€59.75 3577639	€46.50 3577691	€33.20 3720868	€39.90 3853641
Designer black floral	€66.50 3705902	–	€66.50 3705919	€73 3821701	€59.75 3821718	€39.90 3705926	€46.50 3849781
Designer black & white patterned glass	€119 3701324	–	€106 3852347	–	–	€59.75 3798577	€73 3852309
Designer cream and white patterned glass	–	–	€106 3852354	–	–	€59.75 3798584	€73 3852323

Accent doors These give you even more opportunities to create a personalised look as well as a practical mirrored option.

Mirror	€119 3577486	–	€66.50 3700952	–	–	€53 3852392	€59.75 3852378
Frosted glass	€119 3577493	–	–	–	–	–	–

Fitted chest cabinets



	Single dressing table (freestanding)	Single dressing table (fitted)	Double dressing table (freestanding or fitted)	2 Drawer bedside cabinet	3 Drawer bedside cabinet	5 Drawer tallboy cabinet	2 Drawer mid bedside cabinet	3 Drawer mid bedside cabinet	2 Over 2 drawer wide cabinet	2 Over 3 drawer wide cabinet
	H747 x W925 x D578mm*	H747 x W900 x D578mm*	H747 x W1360 x D578mm*	H549 x W460 x D578mm*	H747 x W460 x D578mm*	H1141 x W460 x D578mm*	H549 x W610 x D578mm*	H747 x W610 x D578mm*	H747 x W910 x D578mm*	H942 x W910 x D578mm*
	3 drawer pedestal with soft-close trinket drawer pedestal can be fitted left hand or right hand	fits between two wardrobes beneath full depth double bridging unit 3 drawer pedestal with soft-close trinket drawer pedestal can be fitted left hand or right hand	twin 3 drawer pedestals with soft-close trinket drawer can be used freestanding or fitted between two wardrobes beneath a full depth double and single bridging unit	2 soft-close drawers	3 soft-close drawers	5 soft-close drawers	2 soft-close drawers	3 soft-close drawers	2 wide and 2 narrow soft-close drawers	3 wide and 2 narrow soft-close drawers
Ferrara oak style	€192 3860809	€172 3862506	€266 3860847	€113 3854013	€139 3854099	€179 3854570	€126 3854051	€166 3854532	€199 3854617	€226 3854655
Walnut style	€192 3860823	€172 3862520	€266 3860861	€113 3854037	€139 3854518	€179 3854594	€126 3854075	€166 3854556	€199 3854631	€226 3854679
Maple style	€192 3860816	€172 3862513	€266 3860854	€113 3854020	€139 3854501	€179 3854587	€126 3854068	€166 3854549	€199 3854624	€226 3854662
Cream	€192 3860830	€172 3862537	€266 3860878	€113 3854044	€139 3854525	€179 3854600	€126 3854082	€166 3854563	€199 3854648	€226 3854686
You will also need	3 x handles 3 drawer bedside front pack worktop	3 x handles 3 drawer bedside front pack worktop	6 x handles 2 x 3 drawer bedside front pack worktop	2 x handles 2 drawer bedside pack worktop	3 x handles 3 drawer bedside pack worktop	5 x handles 5 drawer tallboy pack worktop	2 x handles 2 drawer mid bedside pack worktop	3 x handles 3 drawer mid bedside pack worktop	6 x handles 2 over 2 drawer pack worktop	8 x handles 2 over 3 drawer pack worktop

*Dimensions include worktop (purchased separately). See opposite. Chest width without worktop is 10mm less.

Fitted chest drawer front packs

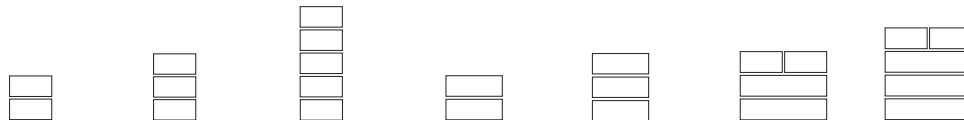

	2 Drawer bedside pack W446	3 Drawer bedside chest pack W446	5 Drawer tallboy pack W446	2 Drawer mid bedside pack W596	3 Drawer mid bedside pack W596	2 Over 2 drawer wide chest pack W896	2 Over 3 drawer wide chest pack W896
--	-------------------------------	-------------------------------------	-------------------------------	-----------------------------------	-----------------------------------	---	---

Contemporary drawer fronts

Designer cappuccino gloss	€46.50 3850398	€53 3850404	€73 3850411	€53 3850428	€66.50 3850435	€79.75 3850442	€93 3850459
Designer vanilla gloss	€46.50 3850121	€53 3850145	€73 3850169	€53 3850176	€66.50 3850190	€79.75 3850206	€93 3850213
Designer white gloss	€46.50 3850237	€53 3850244	€73 3850251	€53 3850268	€66.50 3850275	€79.75 3850282	€93 3850299
Designer black gloss	€46.50 3849712	€53 3849729	€73 3849736	€53 3849743	€66.50 3849750	€79.75 3849767	€93 3849774
Ferrara oak style	€39.90 3850695	€46.50 3850701	€66.50 3850718	€46.50 3850725	€59.75 3850732	€79.75 3850749	€93 3859858
Walnut style	€39.90 3853436	€46.50 3853443	€66.50 3853450	€46.50 3853467	€59.75 3853474	€79.75 3853498	€93 3853511

Multicolour drawer fronts

Designer burgundy gloss	€46.50 3850312	€53 3850329	€73 3850336	€53 3850343	€66.50 3850350	€79.75 3850367	€93 3850374
-------------------------	----------------	-------------	-------------	-------------	----------------	----------------	-------------

Authentic drawer fronts

Maple style shaker	€46.50 3849996	€53 3850015	€73 3850039	€53 3850053	€66.50 3850060	€79.75 3850084	€93 3850091
Ferrara oak style shaker	€46.50 3852620	€53 3852644	€73 3852651	€53 3852675	€66.50 3852699	€79.75 3852712	€93 3852743
Walnut style shaker	€46.50 3852514	€53 3852521	€73 3852545	€53 3852569	€66.50 3852576	€79.75 3852590	€93 3852613
Cream style shaker	€46.50 3852750	€53 3852774	€73 3852798	€53 3852811	€66.50 3852828	€79.75 3852842	€93 3852866

Heritage drawer fronts

Traditional cream	€46.50 3853542	€53 3853559*	€73 3853566▲	€53 3853573	€66.50 3853580*	€79.75 3853603■	€93 3853627●
Traditional maple style	€46.50 3853658	€53 3853665*	€73 3853672▲	€53 3853689	€66.50 3853696*	€79.75 3853719■	€93 3853733●
Designer black floral	€46.50 3849798	€53 3849804	€73 3849811	€53 3849828	€66.50 3849835	€79.75 3849842	€93 3849859

*Top drawer unrouted/plain ■ Top 2 drawers unrouted/plain ▲ Top 3 drawers unrouted/plain
● Top 2 drawers + topmost full width drawer unrouted/plain

Worktops

	460mm	610mm	910mm	925mm	1360mm	1510mm	3050mm*
Ferrara oak style	€33.20 3860649	€46.50 3860656	€53 3850879	€59.75 3850886	€73 3850893	€79.75 3859872	€119 3850909
Walnut style	€33.20 3860663	€46.50 3860670	€53 3850916	€59.75 3850923	€73 3850930	€79.75 3859889	€119 3850947
Maple style	€33.20 3860625	€46.50 3860632	€53 3850831	€59.75 3850848	€73 3850855	€79.75 3859865	€119 3850862
Cream	€33.20 3860687	€46.50 3860694	€53 3850954	€59.75 3850961	€73 3850978	€79.75 3859896	€119 3850985

*Supplied with unfinished ends – edging tape will be required if your worktop ends are visible (see page 19).

Worktops can be purchased ready sized and fully edged for freestanding chests and dressing tables or in longer lengths allowing you to create a more seamless look over several chests at the same height. You can also use some of the wider, fully edged tops over multiple chest combinations.

For example: a 910mm top will fit exactly over 2 x 450mm chests side by side.

Worktop selector



	Standard top	When fitted against a stable wardrobe**
Single dressing table (freestanding)	925mm	1360mm
Single dressing table (fitted)	910mm	n/a
Double dressing table	1360mm	1510mm
2 Drawer bedside cabinet	460mm	610mm
3 Drawer bedside cabinet	460mm	610mm
5 Drawer tallboy cabinet	460mm	n/a
2 Drawer mid bedside cabinet	610mm	910mm
3 Drawer mid bedside cabinet	610mm	910mm
2 Over 2 drawer wide cabinet	910mm	1360mm
2 Over 3 drawer wide cabinet	910mm	n/a

**Worktop will require trimming at the wardrobe end.

Choose your finishing touches

Finish off in style with colour-matched decorative trims, cornice, plinths and panels



	Contemporary trim horizontal 1.8m L1800 x H125 x D40mm	Contemporary trim horizontal 2.7m L2700 x H125 x D40mm	Contemporary vertical trim (pack of 2) L2152 x H125 x D40mm	Cornice L3050 x H90 x D30mm	Plinth L3050 x H75 x D18mm
Ferrara oak style	€46.50 3576311	€59.75 3576380	€73 3574447	€33.20 3567715	€26.60 3567753
Walnut style	€46.50 3576335	€59.75 3576601	€73 3574461	€33.20 3577752	€26.60 3577783
Maple style	€46.50 3576304	€59.75 3576373	€73 3574430	€33.20 3567708	€26.60 3567746
Cream	–	–	–	€33.20 3577769	€26.60 3577790

	Décor panel Colour-matched décor panels can be used as headboards or fillers to bridge any spaces for a fully fitted look. L2112 x W440 x D15mm	Infill panel Colour-matched infill panels can be used to bridge ceilings and any spaces for a fully fitted look for your sliding doors and modular bedrooms. Can be cut to required size. Available in four sizes:			
		L2500 x W110 x D15mm	L2500 x W250 x D15mm	L2500 x W450 x D15mm	L2500 x W610 x D15mm
Ferrara oak style	€35.90 3574287	€27.90 3791332	€35.90 3854952	€42.50 3854990	€55.75 3790991
Walnut style	€35.90 3574508	€27.90 3791349	€35.90 3854976	€42.50 3855010	€55.75 3791301
Maple style	€35.90 3574270	€27.90 3791356	€35.90 3854969	€42.50 3855003	€55.75 3791318
Cream	€35.90 3574539	€27.90 3791363	€35.90 3854983	€42.50 3855027	€55.75 3791325

	Wardrobe scribing trim Perfect for scribing in uneven walls. L2175 x W70 x D10mm	Edging tape Perfect for finishing trimmed panel or worktop edges. L10m x D25mm	Clad on wardrobe end panels Can also be cut down for smaller filler panels. L2112 x W611 x D18mm
Ferrara oak style	€19.95 3853047	€14.60 3855041	–
Walnut style	€19.95 3853054	€14.60 3855065	–
Maple style	€19.95 3853061	€14.60 3855058	–
Cream	€19.95 3853078	€14.60 3855072	–
Black gloss	–	–	€86.25 3860700
Vanilla gloss	–	–	€86.25 3850466
White gloss	–	–	€86.25 3850473
Burgundy gloss	–	–	€86.25 3850480
Cappuccino gloss	–	–	€86.25 3850497

* Furniture not included

Freestanding chests

Supplied flat packed and complete with cabinet and drawer packs – all you need to do is choose your handles separately. See handles on pages 21-22

Contemporary chests



	Dressing table
	H680 x W1000 x D464mm
Walnut style	-
Maple style	€159 3575413

Traditional chests



	Bedside chest	3 Drawer wide chest	2 Over 4 drawer chest	3 Over 4 drawer chest
	H526 x W519 x D491mm	H720 x W900 x D491mm	H1102 x W900 x D491mm	H845 x W1282 x D491mm
Walnut style	-	€172 3574980	€246 3598450	€272 3598467
Maple style	€113 3574874	€172 3574935	-	€272 3598382
White	€113 3574881	€172 3574942	-	-
Cream	-	-	-	-

Shaker chests



	Bedside chest	3 Drawer wide chest	2 Over 4 drawer chest	3 Over 4 drawer chest	Dressing table
	H490 x W400 x D464mm	H680 x W800 x D464mm	H1062 x W800 x D464mm	H805 x W1197 x D464mm	H680 x W1000 x D464mm
Ferrara oak style	€126 3798645	-	€246 3830703	€272 3830741	-
Walnut style	€126 3798744	€172 3798751	-	-	€246 3798782
Maple style	€126 3798591	-	-	€272 3830765	€246 3798638
Cream	-	-	€246 3830734	€272 3830772	€246 3798737

don't forget...

You can upgrade your freestanding chests to have soft-close drawers.*

Pack of 2 3574348 **€19.95**

*While stocks last.

Designer freestanding chests

Create your very own designer chest with this flexible modular system. Cabinets and drawer packs are available separately which means you can mix and match to complement your wardrobe selection.

To finish things off in style, you just need to accessorise with the handle of your choice (see pages 24-25). Designer chests come flat packed for you to assemble

1. choose your cabinets



	Bedside chest	3 Drawer wide chest	Dressing table	3 Plus 3 drawer chest
	H511 x W500 x D440mm	H703 x W1000 x D440mm	H703 x W1964 x D440mm	H703 x W1424 x D440mm
Ferrara oak style	€159 3575482	€212 3575659	€266 3737262	€312 3721117
Walnut style	€159 3575512	€212 3575703	€266 3737279	€312 3721131
Maple style	€159 3575475	€212 3575628	€266 3737286	€312 3721124

3. choose your plinths

	Bedside chest	3 Drawer wide chest	Dressing table	3 Plus 3 drawer chest
Ferrara oak style	€19.95 3798904	€33.20 3798928	€19.95 3798928	€39.90 3798959
Walnut style	€19.95 3798973	€33.20 3798997	€19.95 3798997	€39.90 3799024
Maple style	€19.95 3799055	€33.20 3799079	€19.95 3799079	€39.90 3799086

2. choose your drawer fronts

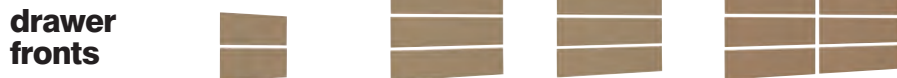

	Bedside chest	3 Drawer wide chest	Dressing table	3 Plus 3 drawer chest
Vanilla gloss	€46.50 3567609	€59.75 3567616	€59.75 3567616	€73 3567623
Burgundy gloss	€46.50 3567678	€59.75 3567685	€59.75 3567685	€73 3567692
White gloss	€46.50 3567463	€59.75 3567470	€59.75 3567470	€73 3567487
Cappuccino gloss	€46.50 3705728	€59.75 3705742	€59.75 3705742	€73 3705773
Black gloss	€46.50 3705971	€59.75 3705988	€59.75 3705988	€73 3705995
Black floral	€46.50 3821725	€59.75 3821732	€59.75 3821732	€73 3821749

Choose your interiors & accessories

Create smart interiors which look great and meet your individual storage needs. Select your choice of interiors from the numbered options below – most items are available in sizes to fit both single and double width cabinets.



Single cabinet W450mm Double cabinet W900mm

M Modular **S** Sliding doors **F** Freestanding

Look out for these symbols to check compatibility with each of our furniture ranges

Single and double wardrobe cabinets both come complete with one shelf and hanging rail



Shelving and storage



1 Shelf pack

■ Pack of 2

Single **M** H18 x W420 x D559mm
3574683 **€39.90**

Double **M** H18 x W870 x D559mm
3574676 **€46.50**



Glass shelf

Single **M** H6 x W418 x D486mm
3718971 **€19.95**

Double **M** H6 x W868 x D486mm
3718988 **€26.60**



2 Interior cube storage pack

■ Will also fit vertically in a single wardrobe cabinet

M H420 x W870 x D350mm

3574720 **€66.50**

Fits horizontally in double wardrobe cabinets or vertically in single wardrobe cabinets

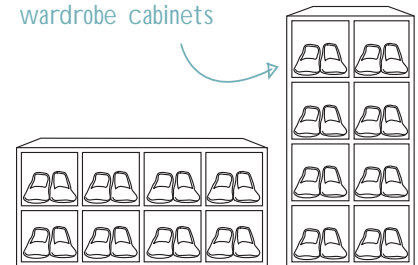

Drawers



③ 3 Drawer chest

Single **M**
H681 x W420 x D442mm
3574638 **€133**

Double **M**
H681 x W870 x D442mm
3574645 **€159**



④ Interior storage drawer

Single **M**
H158 x W420 x D486mm
3574706 **€53**

Single with lock **M**
H173 x W420 x D488mm
3574713 **€59.75**

Double **M**
H158 x W870 x D486mm
3574690 **€59.75**



⑤ Pull-out wire basket

■ Smooth action runners

Single **M**
H120 x W420 x D500mm
3581070 **€39.90**

Double **M S**
H120 x W870 x D500mm
3581087 **€53**



⑥ Pull-out grey fabric container

■ Smooth action runners

Single **M**
H130 x W420 x D500mm
3581094 **€39.90**

Double **M S**
H130 x W870 x D500mm
3581100 **€53**

Hanging rails



⑦ Pull-down hanging rail

■ Minimum internal width of 870mm required

Double **M S**
H840 x W785 x D140mm
3581131 **€46.50**

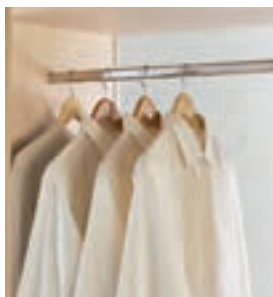

Standard hanging rail

Single **M**
H45 x W414 x D20mm
3574669 **€7.95**

Double **M S**
H45 x W864 x D20mm
3574652 **€10.60**

Pull out accessories

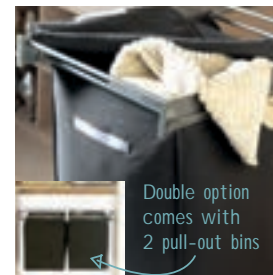

⑧ Pull-out grey laundry bin

■ Smooth action runners

Single **M**
H480 x W420 x D500mm
3691137 **€46.50**

Double **M S**
H480 x W870 x D500mm
3691113 **€59.75**

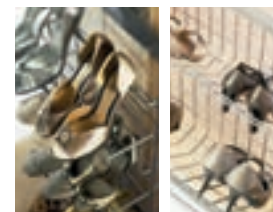

⑩ Pull-out side mounted shoe rack

■ Suitable for wardrobes with an internal depth of more than 540mm and height of 850mm

M S F
H840 x W220 x D510mm
3581063 **€59.75**

Pull-out shoe rack

■ Smooth action runners

Double **M S**
H235 x W870 x D512mm
3691120 **€59.75**



⑨ Pull-out tie rack

■ Suitable for wardrobes with an internal depth of over 480mm

M S F H89 x W89 x D455mm
3504895 **€13.30**

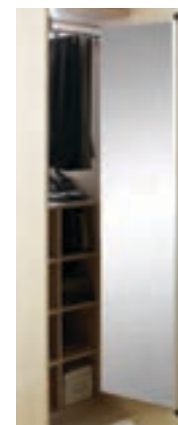

Swing-out mirror

■ Please check overall size of mirror fits within overall size of door (height between fixing holes 1423mm)

M S
H1400 x W328 x D8mm
3504918 **€59.75**

Choose your handles

From sleek minimalist designs to ornate traditional styles, we have a handle in our range to suit all tastes and every bedroom. Don't forget, you can even mix and match handles to create your very own look.

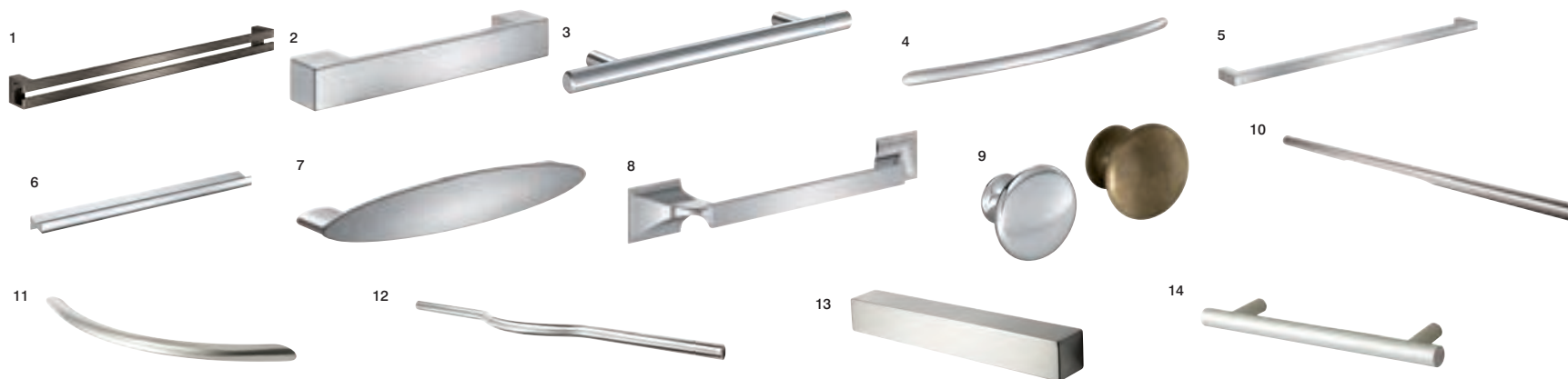

1. Parallel handle SS

■ Black nickel

L138 x W25 x H27mm	5397007041781	€3.95 /each
L330 x W25 x H27mm	5397007041804	€6.65 /each

2. Chunky square handle SS

■ Bright chrome

L163 x W25 x H28mm	5397007041828	€3.95 /each
L259 x W25 x H28mm	5397007041842	€6.65 /each

3. Rod handle SS

■ Stainless steel

L192 x W12 x H35mm	5397007041866	€3.95 /each
--------------------	---------------	-------------

4. Bow handle SS

■ Bright chrome

L186 x W15 x H26mm	5397007041880	€3.95 /each
L296 x W15 x H26mm	5397007041903	€6.65 /each

5. Square handle SS

■ Bright chrome

L136 x W9 x H28mm	5397007041927	€3.95 /each
L328 x W9 x H28mm	5397007041941	€6.65 /each

6. Rail handle SS

■ Polished aluminium

L180 x W10 x H15mm	5397007041965	€3.95 /each
L660 x W10 x H15mm	5397007041989	€6.65 /each

7. Oval handle SS

■ Brushed nickel

L170 x W28 x H25mm	5397007042009	€3.95 /each
--------------------	---------------	-------------

8. Traditional handle SS

■ Bright chrome

L175 x W25 x H28mm	5397007042023	€3.95 /each
--------------------	---------------	-------------

9. Traditional knob SS

■ Bright chrome

L31 x W31 x H25mm	5397007042047	€3.95 /each
-------------------	---------------	-------------

■ Bronze finish	L35 x W35 x H32mm	5397007042061	€3.95 /each
-----------------	-------------------	---------------	-------------

10. Cylinder handle* 6

■ Brushed nickel effect

L196 x W18 x H18mm	3580356	€13.30 /pair
L546 x W18 x H18mm	3580370	€33.20 /pair
L996 x W18 x H18mm	3580363	€46.50 /pair

11. Wire bow handle 6

■ Matt nickel effect

L150 x W10 x H32mm	3580318	€5.30 /pair
L190 x W10 x H32mm	3580325	€9.30 /pair

■ Brushed nickel effect

L150 x W10 x H32mm	3580752	€5.30 /pair
L190 x W10 x H32mm	3580745	€9.30 /pair
L377 x W10 x H34mm	3580738	€14.60 /pair

12. Oval section handle* 6

■ Brushed nickel effect

L260 x W14 x H28mm	3691021	€11.95 /pair
L504 x W14 x H36mm	3691038	€17.25 /pair
L606 x W14 x H38mm	3690949	€10.60 /pair

13. Square cup handle 6

■ Brushed nickel effect

L170 x W25 x H28mm	3580332	€11.95 /pair
L330 x W25 x H28mm	3580349	€14.60 /pair

14. Rod handle 6

■ Aluminium effect

L168 x W12 x H35mm	3242605	€1.95 /pair
L238 x W12 x H35mm	3242612	€2.65 /pair
L238 x W12 x H35mm	3580769	€5.30 /pair

■ Brushed nickel effect

L128 x W12 x H35mm	3242629	€1.95 /pair
L168 x W12 x H35mm	3580707	€5.30 /pair
L232 x W12 x H35mm	3691090	€7.95 /pair
L328 x W12 x H35mm	3580691	€10.60 /pair

Choose your handles



15. Wavy bow handle 6

■ Brushed nickel effect

L97 x W19 x H22mm 3580578

€2.65 /pair

16. Scoop handle 6

■ Satin chrome effect

L160 x W38 x H25mm 3690956

€4.65 /pair

17. Loop knob 6

■ Brushed nickel effect

L58 x W60 x H30mm 3691076

€10.60 /pair

18. Solid oval knob 6

■ Brushed nickel effect

L34 x W16 x H24mm 3242186

€1.30 /pair

L34 x W16 x H24mm 3580271

€2.65 /pair

19. Glitzy square knob 6

■ Chrome effect

L25 x W25 x H22mm 3690970

€4.65 /pair

20. Wing handle 6

■ Black nickel effect

L172 x W24 x H18mm 3690963

€9.30 /pair

21. Ceramic knob 6

■ Cracked cream effect

L38 x W38 x H31mm 3580509

€5.30 /pair

22. Football knob 6

■ Black/white

L38 x W38 x H39mm 3580608

€2.65 /pair

23. Square pull knob 6

■ Brushed nickel effect

L24 x W17 x H21mm 3242681

€1.30 /pair

L24 x W17 x H21mm 3580301

€2.65 /pair

■ Aluminium effect

L24 x W17 x H21mm 3580295

€2.65 /pair

24. Flip handle 6

■ Satin chrome effect

L40 x W40 x H8mm 3580226

€2.65 /pair

L72 x W40 x H8mm 3580233

€4.65 /pair

25. Rope style knob 6

■ Antique brass effect

L29 x W29 x H23mm 3580202

€5.30 /pair

■ Antique pewter effect

L29 x W29 x H23mm 3580219

€5.30 /pair

26. Tear drop handle 6

■ Matt black

L67 x W27 x H24mm 3580196

€2.65 /pair

27. Cylinder knob 6

■ Brushed nickel effect

L44 x W12 x H35mm 3690994

€2.65 /pair

28. Small conical knob 6

■ Matt chrome effect

L20 x W20 x H24mm 3580387

€2.65 /pair

29. Large conical knob 6

■ Satin chrome effect

L25 x W25 x H25mm 3580394

€3.95 /pair

30. Cup handle 6

■ Antique pewter effect

L90 x W41 x H25mm 3580561

€2.65 /pair

31. Cup handle 6

■ Satin nickel effect

L94 x W28 x H21mm 3580554

€2.65 /pair

32. Edge handle 6

■ Brushed nickel effect

L40 x W20 x H47mm 3580622

€2.65 /pair

Do more with your space!

Create more space in your home with our sliding wardrobe doors and clever internal storage systems. They utilise every inch of space – wasting none!

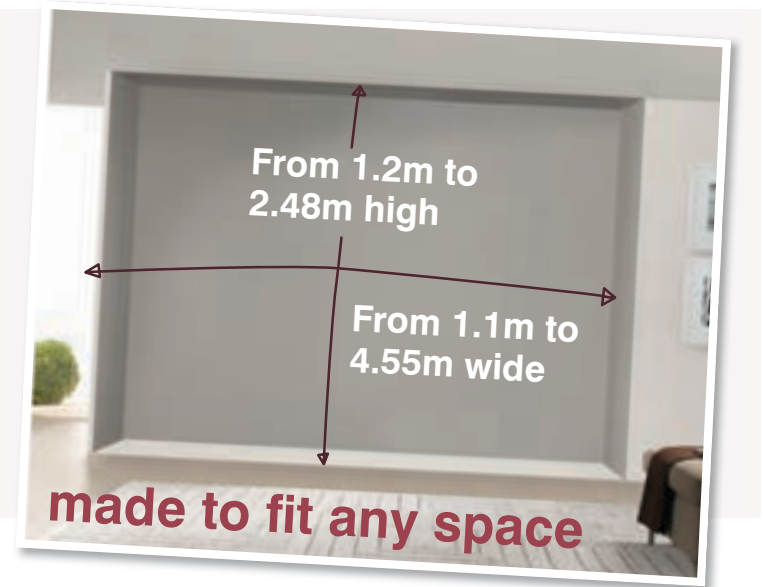

Tailor-made doors

Shaker style sliding doors



Minimalist style sliding doors



Switch style double sided sliding doors



Designing your **tailor-made doors**

Shaker sliding doors

Available in 2, 3 and 4 panel design. Choose from a selection of glass and wood effect panels, then frame them in the classic shaker design available in matching wood effects or silver effect.

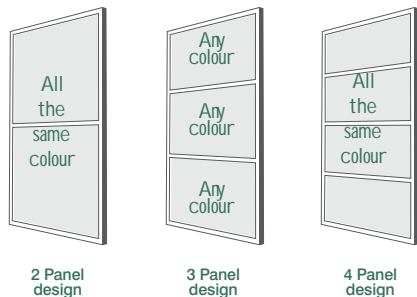

available finishes

Using the illustrations above as a guide, design your preferred door style using the finishes below.

Glass colours:

Mirror
Grey mirror (GM)
Black
Maroon
Soft white
Cappuccino
Cream
Pure white
Blue shadow

Wood effect finishes:

Ferrara oak
Windsor oak
Aida walnut
Maple

Matching frame finishes:

Ferrara oak
Windsor oak
Aida walnut
Maple
Silver

Minimalist sliding doors

Available in a 2 and 4 panel design. Choose from any of our 18 glass and wood effect panels encased within a sleek aluminium frame.

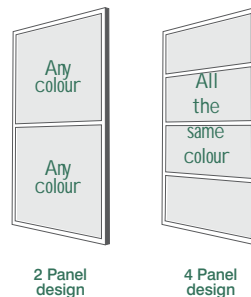

Glass colours:

Mirror
Grey mirror (GM)
Black
Maroon
Soft white
Cappuccino

Cream
Pure white
Blue shadow
Louvre pattern glass
Floral pattern glass

Wood effect finishes:

Ferrara oak
Windsor oak
Aida walnut
Maple
Gloss walnut
Gris (textured)
Linen

Switch sliding doors

The new Switch style creates an instant 'WOW' factor for any room in the home. The double sided design means that these are great for that walk-in closet or room divides.

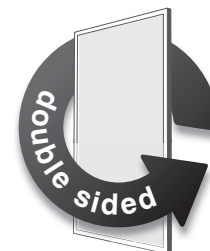

Single panel, double sided design

don't

forget

Switch doors can have either:

- the same wood effect panel finish on both sides
- the same glass colour on both sides
- one side with glass, the other with mirror or grey mirror

Glass colours:

Mirror
Grey mirror (GM)
Black
Soft white
Cappuccino
Cream
Pure white
Blue shadow

Wood effect finishes:

Windsor oak
Aida walnut

Glass & mirror finishes

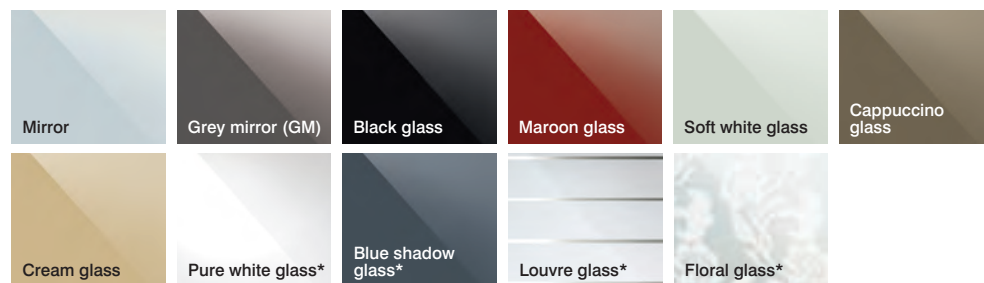

Wood effect finishes

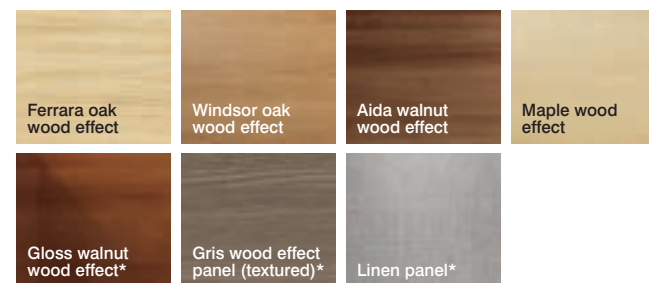

*These colours and finishes are part of our premium range of finishes and colours, and are separately listed in the price list overleaf

Tailor-made doors **price guide**

Soft close is included on all doors over 650mm wide

Shaker style sliding doors

	2 Panel doors	W550 – 740mm	W741 – 913mm	W914 – 1059mm	W1060 – 1160mm
	2 Wood effect	5055332100442 €347	5055332100503 €369	5055332100565 €417	5055332100626 €429
	2 Glass or Grey mirror (GM)	5055332113640 €383	5055332113831 €408	5055332114029 €466	5055332114210 €474
	2 Mirror	5055332100466 €348	5055332100527 €363	5055332100589 €417	5055332100640 €429
	2 Pure white / 2 Blue shadow	5055332113657 €460	5055332113848 €493	5055332114036 €520	5055332114227 €540
	3 Panel doors	W550 – 740mm	W741 – 913mm	W914 – 1059mm	W1060 – 1160mm
	Wood / Wood / Wood effect	0026457941093 €368	0026457941185 €420	0026457941277 €442	0026457941369 €466
	Wood / Glass or GM / Wood effect	5055332113664 €406	5055332113855 €462	5055332114043 €488	5055332114234 €520
	Wood / Mirror / Wood effect	0026457941116 €367	0026457941208 €416	0026457941291 €442	0026457941383 €460
	Glass or GM / Glass or GM / Glass or GM	5055332113671 €413	5055332113862 €466	5055332114050 €496	5055332114241 €510
	Glass or GM / Wood / Glass or GM	5055332113688 €409	5055332113879 €460	5055332114067 €492	5055332114258 €520
	Glass or GM / Mirror / Glass or GM	5055332113695 €408	5055332113886 €468	5055332114074 €493	5055332114265 €520
	Mirror / Mirror / Mirror	0026457941154 €375	0026457941246 €418	0026457941338 €442	0026457941420 €469
	Wood / Pure white / Wood effect	5055332113701 €530	5055332113893 €550	5055332114081 €590	5055332114272 €620
	Wood / Blue shadow / Wood effect				
	Pure white / Pure white / Pure white	5055332113718 €520	5055332113909 €550	5055332114098 €590	5055332114289 €620
	Blue shadow / Blue shadow / Blue shadow				
	Pure white / Wood / Pure white effect	5055332113725 €520	5055332113916 €550	5055332114104 €590	5055332114296 €620
	Blue shadow / Wood / Blue shadow effect				
	Pure white / Mirror / Pure white	5055332113732 €520	5055332113923 €560	5055332114111 €590	5055332114302 €620
	Blue shadow / Mirror / Blue shadow				
Mirror / Pure white / Mirror	5055332113749 €520	5055332113930 €560	5055332114128 €600	5055332114319 €630	
Mirror / Blue shadow / Mirror					
Glass or GM / Pure white / Glass or GM	5055332113756 €520	5055332113947 €550	5055332114135 €580	5055332114326 €620	
Glass or GM / Blue shadow / Glass or GM					
Pure white / Glass or GM / Pure white	5055332113763 €520	5055332113954 €550	5055332114142 €580	5055332114333 €620	
Blue shadow / Glass or GM / Blue shadow					
	4 Panel doors	W550 – 740mm	W741 – 913mm	W914 – 1059mm	W1060 – 1160mm
	4 Wood effect	5055332100688 €371	5055332100749 €416	5055332100800 €442	5055332100862 €460
	4 Mirror	5055332100695 €369	5055332100756 €417	5055332100817 €440	5055332100879 €470
	4 Glass or Grey mirror (GM)	5055332113770 €414	5055332113961 €461	5055332114159 €484	5055332114340 €510
	4 Pure white / Blue shadow	5055332113787 €408	5055332113978 €464	5055332114166 €486	5055332114357 €510
	Shaker trackset*	up to W1830mm	up to W2745mm	up to W3660mm	up to W4555mm
	Matching trackset	0026457941451 €142	0026457941468 €166	0026457941475 €202	0026457941574 €222

Trackset provided to the minimum opening measurement, less 2mm.

* The Shaker top track will be made to match the same wood effect of the chosen frame finish.

** The Minimalist and Switch track-sets are anodised aluminium (silver).

Made to measure track-sets ONLY work with made to measure doors.

The Shaker and Minimalist sliding doors are single sided and not designed to be viewed from the back.

Sliding doors & clever interior storage systems

Minimalist style sliding doors

	2 Panel doors	W550 – 740mm	W741 – 913mm	W914 – 1059mm	W1060 – 1180mm
	Glass & Mirror	0026457941161 €421	0026457941253 €476	0026457941345 €540	0026457941437 €590
	Wood effect (full door)	5055332101234 €442	5055332101302 €480	5055332101371 €530	5055332101449 €590
	Floral pattern / Louvre	0026457941178 €481	0026457941260 €530	0026457941352 €610	0026457941444 €650
	Gloss walnut / Gris (textured) / Linen effect	5055332113602 €530	5055332113794 €590	5055332113985 €670	5055332114173 €720
	Pure white / Blue shadow	5055332113619 €446	5055332113800 €590	5055332113992 €670	5055332114180 €720
	4 Panel doors	W550 – 740mm	W741 – 913mm	W914 – 1059mm	W1060 – 1180mm
	Glass & Mirror	5055332100923 €420	5055332100992 €480	5055332101067 €540	5055332101135 €590
	Wood effect	5055332101517 €416	5055332101586 €484	5055332101654 €530	5055332101722 €590
	Floral pattern / Louvre	5055332100930 €482	5055332101005 €540	5055332101074 €600	5055332101142 €650
	Gloss walnut / Gris (textured) / Linen effect	5055332113626 €530	5055332113817 €590	5055332114005 €670	5055332114197 €720
	Pure white / Blue shadow	5055332113633 €520	5055332113824 €580	5055332114012 €670	5055332114203 €720
	Minimalist trackset*/framing kit	up to W1830mm	up to W2745mm	up to W3660mm	up to W4555mm
	Silver effect	0026457941482 €202	0026457941499 €273	0026457941505 €333	0026457941581 €422

Switch style sliding doors - double sided

	Double sided door		W550 - 740mm		W741 - 914mm	
	Side 1	Side 2				
Mirror / Grey mirror	Mirror / Grey mirror	Mirror / Grey mirror	5055332115866 €414		5055332114876 €510	
Glass	Glass	Glass	5055332115927 €442		5055332115439 €570	
Wood effect	Wood effect	Wood effect	5055332115873 €449		5055332115316 €461	
Mirror & Grey mirror	Glass	Glass	5055332115903 €444		5055332115415 €520	
Pure white / Blue shadow	Mirror / Grey mirror	Mirror / Grey mirror	5055332115880 €520		5055332115330 €560	
Pure white / Blue shadow	Pure white / Blue shadow	Pure white / Blue shadow	5055332115897 €560		5055332115354 €630	
	Switch trackset**	up to W1830mm	up to W2745mm	up to W3660mm	up to W4555mm	
	Silver effect (aluminium)	5055332115811 €147	5055332115828 €180	5055332115835 €195	5055332115842 €207	

Trackset provided to the minimum opening measurement, less 2mm.

* The Shaker top track will be made to match the same wood effect of the chosen frame finish.

** The Minimalist and Switch track-sets are anodised aluminium (silver).

Made to measure track-sets ONLY work with made to measure doors.

The Shaker and Minimalist sliding doors are single sided and not designed to be viewed from the back.

Lighting

Our wardrobe lighting adds mood to the bedroom and is practical too. Suitable for all sliding doors, these lights simply slot between the ceiling and top track.



Solo light

Pack of 2	5055332100473	€106
Pack of 3	5055332100480	€144

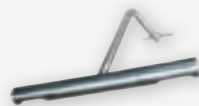

Duo light

Pack of 2	5055332100497	€130
Pack of 3	5055332100534	€198



Infra-red control box for lighting

5055332100541	€65
---------------	------------

Please note: to make lights work automatically you need one infra-red control box for each light pack.

Order
your doors
on page
37

Standard sized sliding doors



For fitting accessories to help build your opening for sliding doors see page 32

Shaker sliding doors



	Doors	White	Windsor oak effect	Alto walnut effect	Ferrara oak effect	Maple effect
W610mm	3 panel	5055332107564 €158	5055332107229 €158	5055332107205 €158	5055332108097 €158	5055332107540 €158
	Single panel	5055332111561 €158	5055332111509 €158	5055332111530 €158	–	–
	Mirror	5055332107557 €158	5055332107212 €158	5055332107199 €158	5055332108080 €158	5055332107533 €158
W762mm	3 panel	3830925 €171	3830987 €171	3831106 €171	5055332100855 €171	3830949 €171
	Single panel	5055332111578 €171	5055332111516 €171	5055332111547 €171	–	–
	Mirror	3830932 €171	3830994 €171	3831113 €171	5055332100848 €171	3830956 €171
W914mm	3 panel	3577936 €184 ^{SS} 3831120 €184	3577998 €184 ^{SS} 3831182 €184	3831205 €184	5055332100909 €184	3831144 €184
	Single panel	5055332111585 €184	5055332111523 €184	5055332111554 €184	–	–
	Mirror	3577943 €184 ^{SS} 3831137 €184	3578001 €184 ^{SS} 3831199 €184	3831212 €184	5055332100893 €184	3831151 €184

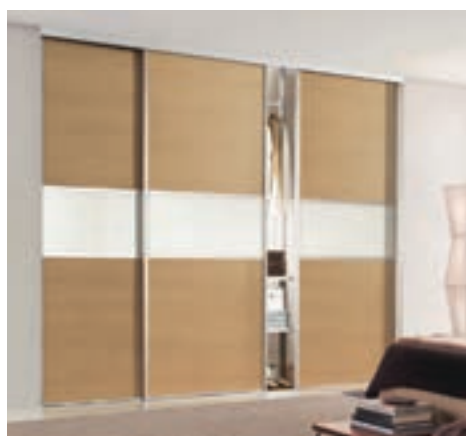

Contemporary sliding doors



Opening height 2260mm	White / soft white glass	Ferrara oak effect / soft white glass	Alto walnut effect / soft white glass	Maple effect / soft white glass
W914mm	3578261 €184 3831229 €184	3831250 €184	3578315 €106 3831267 €184	3831236 €184

Find out how many doors you need on page 33

Dimensions are approximate. All our fixed sized sliding doors fit an opening height of 2260mm. If your ceiling height is greater than this we have accessories to help (see page 32).

Standard sized **sliding doors**



Mirror/glass sliding doors



Opening height 2260mm	White framed mirror door	Silver framed mirror door	Silver framed floral mirror door	Silver framed leaf mirror door	Silver framed louvre mirror door	Silver framed soft white glass door
W610mm	–	3831373 €105	5055332100954 €131	5055332100961 €131	–	5055332115859 €131
W762mm	3115008 €79.75 ^{SS} 3831472 €79.75	3831403 €105	–	–	5055332110922 €144	0026457935801 €144
W914mm	3115015 €86.25 ^{SS} 3831489 €86.25	3831380 €105	–	–	0026457940515 €158	0026457935863 €158

Need help building the opening space for your doors?
See page 32



Select sliding doors



Opening height 2260mm	Mirror	Black glass with silver frame	Pure white glass with silver frame	Windsor oak effect & black glass with matching frame	Windsor oak effect & pure white glass with matching frame	Aida walnut effect & black glass with matching frame	Aida walnut effect & pure white glass with matching frame
W762mm	5055332119871 €251	5055332113312 €264	5055332113343 €264	5055332113299 €251	5055332113336 €251	5055332113275 €251	5055332113329 €251
W914mm	5055332119888 €264	5055332113398 €277	5055332113428 €277	5055332113374 €264	5055332113411 €264	5055332113350 €264	5055332113404 €264

When buying the 'Select' doors, please make sure to order the colour matched 'Select' track set.

Select doors cannot be used or mixed with standard sized track sets and doors.

	up to 1803mm	up to 2745mm	up to 3660mm	up to 4555mm
Matching track set	0026457941451 €142	0026457941468 €166	0026457941475 €202	0026457941574 €226

Please note: the walnut effect doors in the select range are not the same walnut effect finish used for the shaker and contemporary doors.

Dimensions are approximate. All our fixed sized sliding doors fit an opening height of 2260mm. If your ceiling height is greater than this we have accessories to help (see page 28).

Designed for you **sliding doors**



Kids' sliding doors



Opening height 2260mm	Chalkboard	Magnetic white board
W610mm	5055332100916 €113	5055332109834 €246



Panel sliding doors



Opening height 2260mm	White cathedral arch	White decor panel
W762mm	3831359 €82.25	5055332111592 €105
W914mm	3831366 €91.75	5055332111608 €118

additional accessories

Standard tracksets

The length required depends on the opening width of your space. Tracks will need to be cut to size and only fit standard sized sliding doors. These track sets will not work with the 'select' door range.

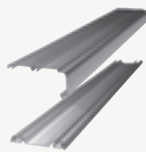

	White	Silver effect
L1193 – 1803mm	3115022 €33.20 ^{SS} 3831564 €33.20 €	3585405 €43.80 ^{SS} 3831595 €43.80 €
L1804 – 2692mm	3115039 €46.50 ^{SS} 3831571 €46.50 €	3585412 €50.50 ^{SS} 3831601 €50.50 €
L2693 – 3607mm	3115046 €51.75 ^{SS} 3831588 €51.75 €	3585429 €61 ^{SS} 3831618 €61 €

These additional fixings will help create your desired opening space. For building down, if your opening space is too large, or for creating an end panel to create a wardrobe.

Fitting accessories

If your opening space is larger than 2260mm high, or you need to fit your doors under your eaves, then use these fitting accessories to help create your needed space.

Opening height reducer

- Pack of 1. Reduce gaps between
127-450mm

3585337 €9.30 ^{SS}
3831533 €9.30 €

Spacer blocks

- Pack of 12. Reduce gaps between
15mm-114mm

3585344 €7.95 ^{SS}
3831540 €7.95 €



Fixing blocks

- Pack of 10

3585351 €6.65 ^{SS}
3831557 €6.65 €

Angled ceiling bracket

- Pack of 2
- Allows top track to fit any angled ceiling between 30-90° - perfect for fitting doors into attic spaces

5055332102101 €9.30 €



End panels & fillets

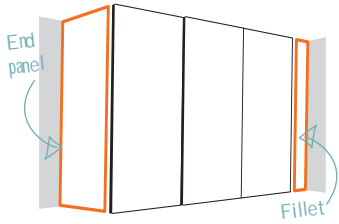

Use our matching end panels and fillets to perfectly finish off your wardrobe, by creating either a side wall or front fascia.

	Aida Walnut wood effect*	Windsor Oak wood effect	Maple wood effect	Ferrara Oak wood effect	White	Alto walnut effect**
Fillets H2750 x W135 x D18mm	5055332113435 €26.60	5055332113459 €26.60	5055332113442 €26.60	5055332113466 €26.60	5055332115941 €26.60	5055332119901 €26.60
End panels H2750 x W593 x D18mm	5055332113473 €66.50	5055332113497 €66.50	5055332113480 €66.50	5055332113503 €66.50	5055332115934 €66.50	5055332119895 €66.50

*Only matches tailor made doors

**Only matches standard doors

Colour-matched fascia strips

Self adhesive trims that fit directly to the front edge of your top track. Available in 4 metre rolls.

Maple effect	3578636 €17.25 ^{SS}
	3831311 €17.25 ⁶
Windsor oak effect	3578698 €17.25 ^{SS}
	3831335 €17.25 ⁶
Alto walnut effect**	3578728 €17.25 ^{SS}
	3831342 €17.25 ⁶
White	3578605 €17.25 ^{SS}
	3831304 €17.25 ⁶

Clever storage systems

Finish off your sliding wardrobe by choosing one of our clever storage systems for your wardrobe interior. These storage systems allow you to utilise every inch of space inside the wardrobe, wasting none.

Standard storage system

Our standard interior system includes 3 hanging bars and 1 shelving unit, which will fit any opening up to 2825mm wide. Also available are matching drawer units that sit between the shelves.



Standard interior unit

H2032 x W365 - 2835 x D381mm

The standard interior unit has cut to fit hanger bars.

White	3585382	€73 ^{SS}
	3831519	€73 ⁶
Beech effect	3585399	€73 ^{SS}
	3831502	€73 ⁶

Please note: Add on additional interior units if you want to extend this to fit wider openings.

Standard interior drawer pack

H157 x W340 x D335mm

Fit between 2 shelves. 2 drawers per pack (You can install 2 or 4 drawers per unit).

White	3585368	€39.80 ^{SS}
	3831526	€39.80 ⁶
Beech effect	3585375	€39.80 ^{SS}
	3831496	€39.80 ⁶



Clever storage systems 6

Aura storage system



Available in:

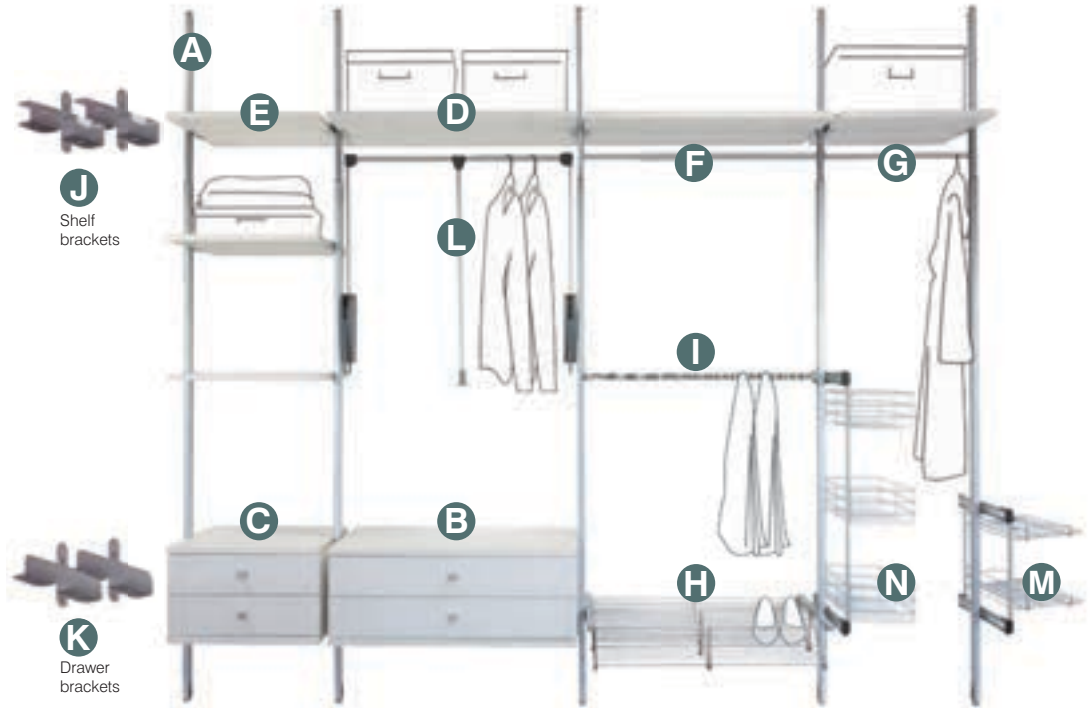
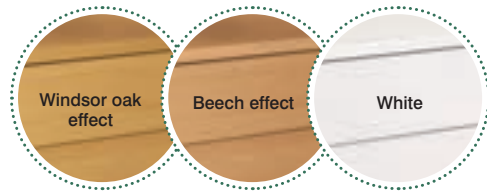

a. Extendable stanchion

■ Silver effect
H2110 - 2700 x W30mm 5055332121638 **€53**

b. Large drawer (900mm)

■ H350 x W900 x D500mm
Beech effect 5055332121799 **€131**
Windsor oak effect 5055332121669 **€131**
White 5055332121676 **€131**

c. Small drawer (550mm)

■ H350 x W550 x D500mm
Beech effect 5055332121805 **€118**
Windsor oak effect 5055332121683 **€118**
White 5055332121690 **€118**

d. Large shelf (900mm)

■ H25 x W900 x D500mm
Beech effect 5055332121829 **€26.60**
Windsor oak effect 5055332121720 **€26.60**
White 5055332121737 **€26.50**

e. Small shelf (550mm)

■ H25 x W550 x D500mm
Beech effect 5055332121812 **€19.95**
Windsor oak effect 5055332121706 **€19.95**
White 5055332121713 **€19.95**

f. extendable hanger bar

■ Silver effect
W720 - 1320mm 5055332121621 **€15.95**

g. Fixed hanger bar

■ Silver effect
W550mm 5055332121782 **€13.30**

h. Shoe rack

■ Silver effect
W900mm 5055332121768 **€39.90**

i. Trousor rack

■ Silver effect
W900mm 5055332121645 **€39.90**

j. Shelf brackets

■ Silver effect
Pack of 2 5055332121614 **€10.60**

k. Drawer brackets

■ Silver effect
Pack of 2 5055332121775 **€10.60**

l. Pull-down extendable hanger bar

■ Silver effect
W830 - 1150mm 5055332121652 **€58.50**

m. Sliding shoe rack

■ Silver effect
H485 x W280 x D485mm 5055332121751 **€58.50**

n. Sliding basket rack

■ Silver effect
H985 x W280 x D460mm 5055332121744 **€91.75**

Please note: Dimensions are approximate. All wood effect colours shown are as close as possible to the actual product. Due to printing restrictions these will vary slightly. Please see in-store for exact product colours and finishes. The Aura storage system cannot be mixed with the Relax storage system, as fitting components are different for each.

Available in:

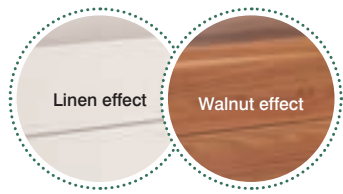

a. Floor to ceiling stanchion

- Silver (cut to fit)
- H2700mm 5055332106093 **€59.75**

Floor to wall stanchion

- Silver (cut to fit)
- H2240 x D255mm 5055332106178 **€59.75**

b. Small matrix (550mm)

- W550 x D500 x H384mm
- Including 2 x drawer box brackets
- Walnut effect 5055332106529 **€78.25**
- Linen effect 5055332106536 **€78.25**

c. Large matrix (900mm)

- W900 x D500 x H384mm
- Including 2 x drawer box brackets
- Walnut effect 5055332106666 **€113**
- Linen effect 5055332106673 **€113**

d. Media box

- W900 x D500 x H188mm
- Including 2 x drawer box brackets
- Walnut effect 5055332106482 **€113**
- Linen effect 5055332106499 **€113**

e. Trouser rack (900mm)

- W900 x D500 x H188mm
- Including 2 x drawer box brackets
- Walnut effect 5055332106505 **€113**
- Linen effect 5055332106512 **€113**

f. Small drawer box (550mm)

- W550 x D500 x H384mm
- Including 2 x drawer box brackets
- Walnut effect 5055332106680 **€146**
- Linen effect 5055332106697 **€146**

Please note:

Dimensions are approximate. All wood effect colours shown are as close as possible to the actual product. Due to printing restrictions these will vary slightly. Please see in-store for exact product colours and finishes.



g. Large drawer box (900mm)

- W900 x D500mm
- Including 2 x drawer box brackets
- Walnut effect 5055332106703 **€172**
- Linen effect 5055332106710 **€172**

h. Pull down extendable hanger bar

- Silver
- Includes brackets
- Depth of hanger bar when fully down is 870mm from the wall

W850-1150mm 5055332107571 **€79.25**

i. Hanger bar

- Silver
- Includes fixings

W1220mm (cut to fit) 5055332106338 **€19.95**

j. Shoe rack

- Silver
- Includes fixings
- W1220mm (cut to fit) 5055332106413 **€46.50**

k. Sliding basket (900mm)

- Silver
- Includes runner/frame/2 brackets
- H200 x W900mm 5055332106253 **€79.25**

l. Large shelf (500mm deep)

- W900 x D500mm
- Including 2 x shelf brackets
- Walnut effect 5055332106932 **€39.90**
- Linen effect 5055332107007 **€39.90**

l. Large shelf (330mm deep)

- W900 x D330mm
- Including 2 x shelf brackets
- Walnut effect 5055332107014 **€33.20**
- Linen effect 5055332107021 **€33.20**

m. Small shelf (500mm deep)

- W550 x D500mm
- Including 2 x shelf brackets
- Walnut effect 5055332107038 **€33.20**
- Linen effect 5055332107045 **€33.20**

m. Small shelf (330mm deep)

- W550 x D330mm
- Including 2 x shelf brackets
- Walnut effect 5055332107052 **€33.20**
- Linen effect 5055332107182 **€33.20**

Measure up & install sliding doors

Creating your sliding wardrobe doors couldn't be simpler. Once you have your doors and trackset at home, fitting them should only take 2-3 hours.

Measuring up

Measure your opening height and width as shown in the diagram below. Take into account your wardrobe interior system and measure up appropriately from the back wall to allow for this. **A minimum of 593mm is recommended for use with our Relax and Aura storage systems.**

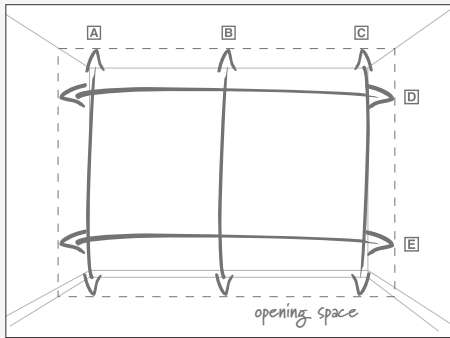

How many sliding doors will you need?

The table below will help you determine how many of our fixed sized sliding doors you will need. (This only applies to the 610 x 762 & 914mm wide doors).

Ideal opening width	2	Door size	Track length
1195mm		610mm	Small: 1803mm
1499mm		762mm	Small: 1803mm
1803mm	914mm	Small: 1803mm	

Ideal opening width	3	Door size	Track length
1780mm		610mm	Small: 1803mm
2236mm		762mm	Medium: 2692mm
2692mm	914mm	Medium: 2692mm	

Ideal opening width	4	Door widths	Trackset length
2390mm		610mm	Medium: 2692mm
2998mm		762mm	Large: 3607mm
3606mm	914mm	Large: 3607mm	

How to install

1. Fit your top track.
2. Fit your bottom track.
3. Lift your doors into place.

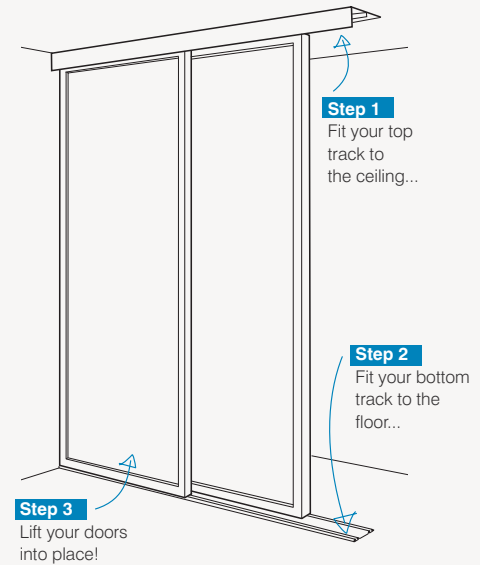

If your opening space too large?

If your opening space is too large then don't worry! We have the accessories to help!

This gap can be reduced by up to 457mm

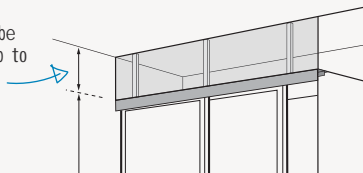

Opening Height Reducer.
(Reduce your height from 127mm to 457mm.)



Spacer Blocks.
Reduce spaces up to 127mm.



Angled Ceiling Bracket.
Allows you to fit doors to angled ceiling.



Fixing Blocks.
Helps fit end panels, for smaller opening.

It's that simple!
..& should only take a few hours to install.

Note: the top and bottom tracks may need to be cut to fit your opening when buying sliding doors, but this is easily done using a standard hacksaw.

Place your **order**

Complete this simple form with your measurements, frame and colour choices and take it in to your nearest store to place your order for home delivery.

Measurements

Enter your 5 point measurements (please see page 36 for guidance):

Floor to ceiling	A	B	C
Wall to wall	D	E	

Note: Due to the amount of overlaps that may be required, the individual door widths will vary slightly from just dividing the opening width by the number of doors needed. All doors per opening are made to an equal width and are made to fit the smallest width and height provided.

Design your doors

Minimalist

All Minimalist doors come complete with stylish aluminium frames.

On 2 panel doors choose either 2 colours for the top and bottom sections. On 4 panel doors all colours must be the same.

		Door design 1	Door design 2
2 panel	Top colour		
	Bottom colour		
Quantity			
4 panel			
Quantity			
Price	€	€	

Shaker

All Shaker doors are available in a choice of frame finishes.

On 3 panel doors you can choose different colours top, middle and bottom. On the 2 and 4 panel doors, panels must be the same colour.

		Door design 1	Door design 2
2 panel			
Quantity			
3 panel	Top colour		
	Middle colour		
	Bottom colour		
Quantity			
4 panel			
Quantity			
Frame colour:			
Price	€	€	

Switch

All Switch doors are double sided.

Choose the same glass colour for the front and back, or have a mirror on one side.

The wood effect panel option is the same finish front and back.

		Door design 1	Door design 2
Double Sided	Side 1		
	Side 2		
Quantity			
Price	€	€	

Your details

All made-to-measure items are home delivered. Please enter your details below.

Name:

Address:

Postcode:

Telephone:

Mobile:

Email:

Signature:

All items are made according to your measurements. Products cannot be returned or exchanged except in the case of manufacturing faults.

Note: This does not affect your statutory rights.

B&Q Employee information (Complete this section and fax this page to: 00 44 844 980 2436 OR email it to jow@hdhc.com)

And call on 00 44 844 980 2435 to confirm receipt of order.

Name:..... Signature:.....

Contact number:..... Date:..... / .. / ..

B&Q Order No:..... Store code:.....

Trackset

All track sets are individually cut to your opening width taken from your measurements above. These are split into 4 prices per length and are specific to the range of doors chosen. See the relevant pricing tables for this information. These track sets can not be mixed with other tailor-made doors or standard sized doors.

You're in safe hands With B&Q's helpful home improvement service

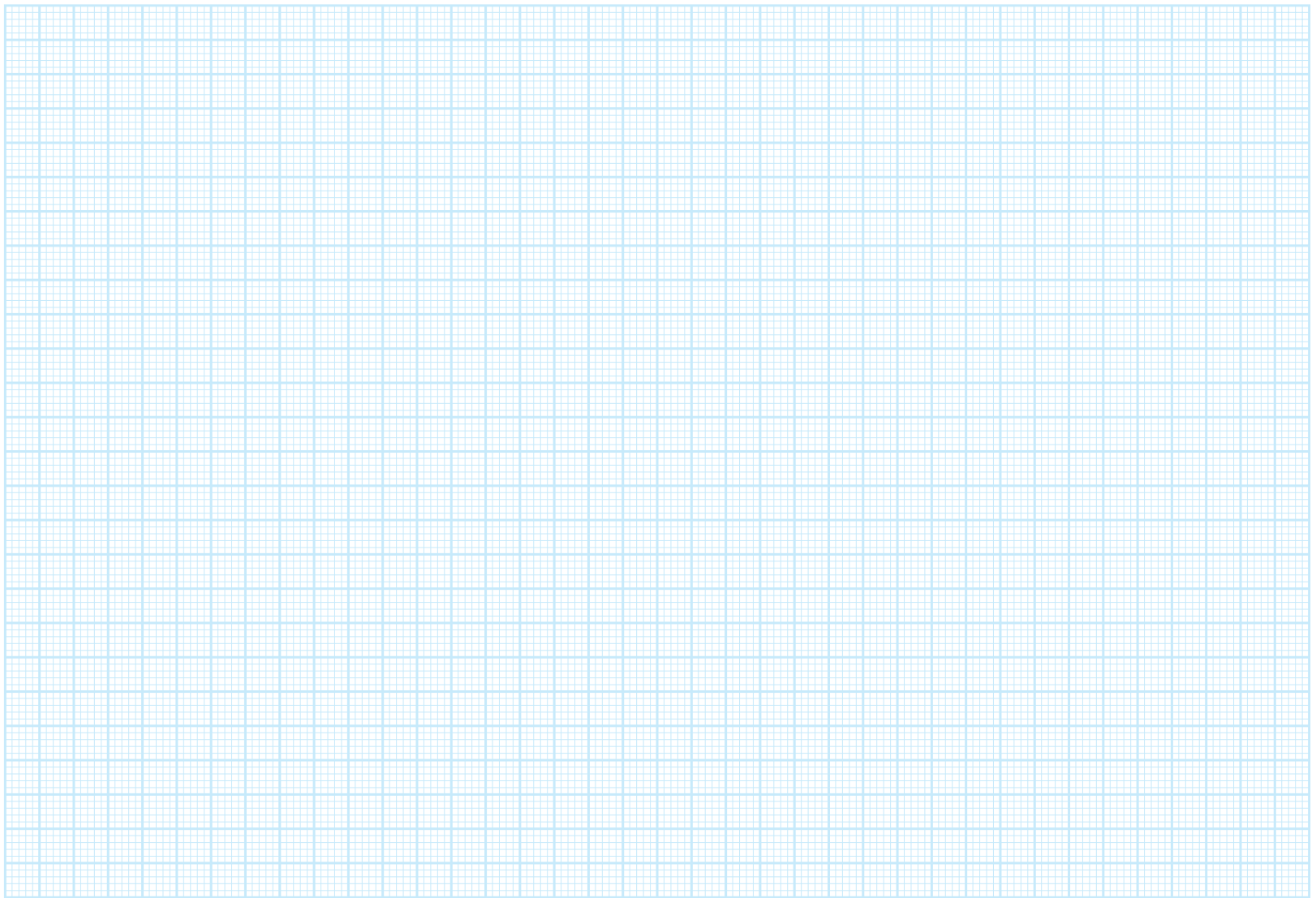

ways to pay

At B&Q you can pay by Mastercard and Visa.



Price promise

If you find the same product or equivalent own brand even 1 cent cheaper within the Republic of Ireland, we'll refund the difference and give you an extra 10% off the lower price.

All we ask is that the lower price is generally available to any potential customer on the day that you call back, within 14 days of purchase, with proof of purchase.

In order to avail of the price promise you must have bought the product at B&Q.

The price promise cannot be redeemed on online purchases, mail order purchases, installation or delivery.

We do not price promise against Retail, Wholesale or Warehouse Clubs requiring membership.

Trade Card and Diamond Card holders can avail of the price promise or use their discount card, not both.

Delivery



Available by home delivery

Items with this logo are available to order for delivery direct to your home*. Delivery times vary depending on the product so please ask at the time of ordering.

Delivery from our specialist delivery team

Order Value*	Home Delivery Charge
€0 – €500	€25
over €500	FREE

*Charges refer to the value of goods being delivered and exclude services.



Products with this logo are available to take home today from all of our stores (dependent on stock).



Products with this logo are available to take home from selected stores, please check with your local store.

If an item isn't in stock your local store will be able to get it for you.

Product detail

All products are subject to availability. All specifications are correct at time of print. Whilst we try to ensure accurate colour representation, please be aware that the photographic process may sometimes alter colours. Some items in our photographs are included for display purposes and are not necessarily intended to be installed as shown with regard to proximity. Please refer to the instructions supplied with your product before installation. A summary of this price guide is available in Braille, large print or on audio cassette. Please ask at your local store for details or email us at diversity@b-and-q.co.uk



When you have finished with this magazine please recycle it.

*All guarantees are manufacturers guarantees. This does not affect your legal rights.

Your nearest store

Store listed in orange is a large B&Q store. Our stores are open from early morning to late evening Monday to Saturday with reduced hours on Sunday.

Athlone Arcadia Centre	090 644 9199
Cork Mahon Point	021 497 2199
Galway Knocknacarra	091 573 400
Liffey Valley Liffey Valley Retail Park	01 6299 499
Limerick City East Retail Park	061 422 499
Naas Newhall Retail Park	045 906 399
Swords Airside Retail Park	01 870 8599
Tallaght Belgard Retail Park	01 6804 650

Our returns policy

Please keep your receipt for anything you buy from us. It will ensure we can help you, if you need to bring something back.

Terms and conditions

If you return a product unused, with the original receipt within 45 days of purchase (or delivery where applicable) we will exchange the product or issue a refund based on the original method of payment. For purchases made by debit/credit card, the same card must be used to process the refund. B&Q customer sales forms are an acceptable form of receipt.

Products that have been cut, made to measure or mixed to your requirements cannot be exchanged or refunded.

We reserve the right to refuse a return or to require proof of identity.

YOUR CONSUMER RIGHTS ARE NOT AFFECTED

If the product you purchase is faulty, or not as described, we may offer an exchange, refund or repair as appropriate, in accordance with your consumer rights.

You can return your items by:

In the first instance, **return via Home Delivery**

- contact us on 1800 946327. Lines are open 8am – 8pm Monday to Saturday and 10am – 4pm Sunday.
- e-mail us at home.delivery@b-and-q.co.uk
- write to us at B&Q Customer Services, Torrance House, Erskine Harbour, Erskine, Renfrewshire PA8 6PA

Alternatively, return the product to your local B&Q store

- you will need to take the product, your receipt/sales advice and the debit/credit card you used for payment with you



When you have finished with
this magazine please recycle it.



You can do it